

RESTRICTED

RESTRICTED

ALASKA  
METAL CREEK QUADRANGLE  
GRID ZONE "A" BAND II N  
N6115-W14830/15X30

WAR DEPARTMENT  
CORPS OF ENGINEERS, U. S. ARMY

CONSERVATION BRANCH  
RECEIVED  
FEB 7 1947  
GEOLOGICAL SURVEY

ALASKA  
METAL CREEK QUADRANGLE  
GRID ZONE "A" BAND II N  
15X30 MINUTE SERIES

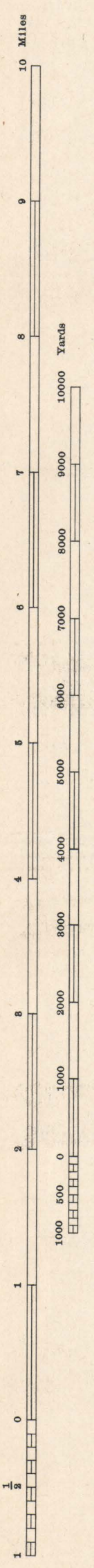
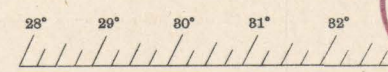

Prepared under the direction of the Chief of Engineers, U. S. Army, 1943.  
Horizontal Control by 29th Engineers, U. S. Army, 1941.  
Vertical Control by 29th Engineers, U. S. Army, 1941.  
Topography by 29th Engineers, U. S. Army, 1943, utilizing multiplex aero-  
projectors, from Tandem T-3A (5 lens) aerial photographs.  
Photography by 2nd Photographic Squadron, Air Corps, U. S. Army, 1941.  
Polyconic Projection, Valdez Datum.  
Not of standard accuracy.

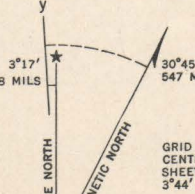
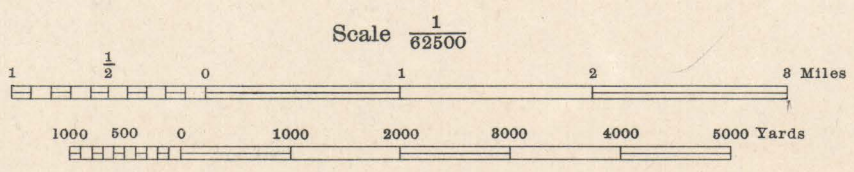

FILE COPY

**ROAD CLASSIFICATION**  
Dependable hard surface, heavy duty road  
Loose surface graded, dry weather road  
Secondary, hard surface, all weather road  
Dirt road  
More than two lanes indicated by note with tick at point of change.  
Road Data 1942

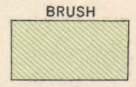

CLASSIFICATION CANCELLED BY  
AUTHORITY OF CHIEF OF ENGINEERS  
LETTER OF  
JAN 22 1946

NOTE: OFFICERS USING THIS MAP WILL MAKE HEREON CORRECTIONS AND ADDITIONS WHICH COME TO THEIR ATTENTION AND MAIL DIRECT TO "THE CHIEF OF ENGINEERS, WASHINGTON, D. C."

APPROXIMATE MEAN DECLINATION 1943 FOR CENTER OF SHEET  
ANNUAL MAGNETIC CHANGE 0.3" DECREASE  
GRID DEC. AT THE CENTER OF THE SHEET FOR ZONE "A" BAND II N  
27° 11' 30" W OR 62 MILS  
USE DIAGRAM ONLY TO OBTAIN NUMERICAL VALUES. TO DETERMINE MAGNETIC NORTH LINE, CONNECT THE PIVOT POINT "P" ON THE SOUTH EDGE OF THE MAP WITH THE VALUE OF THE ANGLE BETWEEN GRID AND MAGNETIC NORTH AS PLOTTED ON THE DEGREE SCALE AT THE NORTH EDGE OF THE MAP.

RESTRICTED  
METAL CREEK, ALASKA  
N6115-W14830/15X30

12