

U.S.L.M. No.7

Boston King Lode Survey 955

U.S. SURVEY No. 1075

Boston King Extension Survey 968

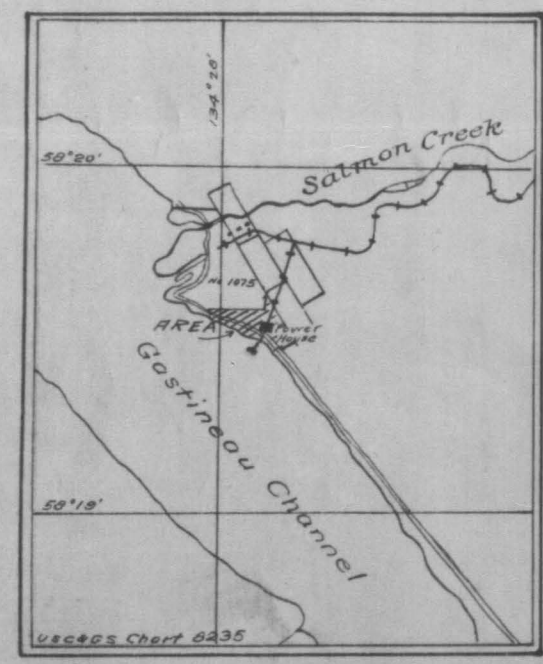
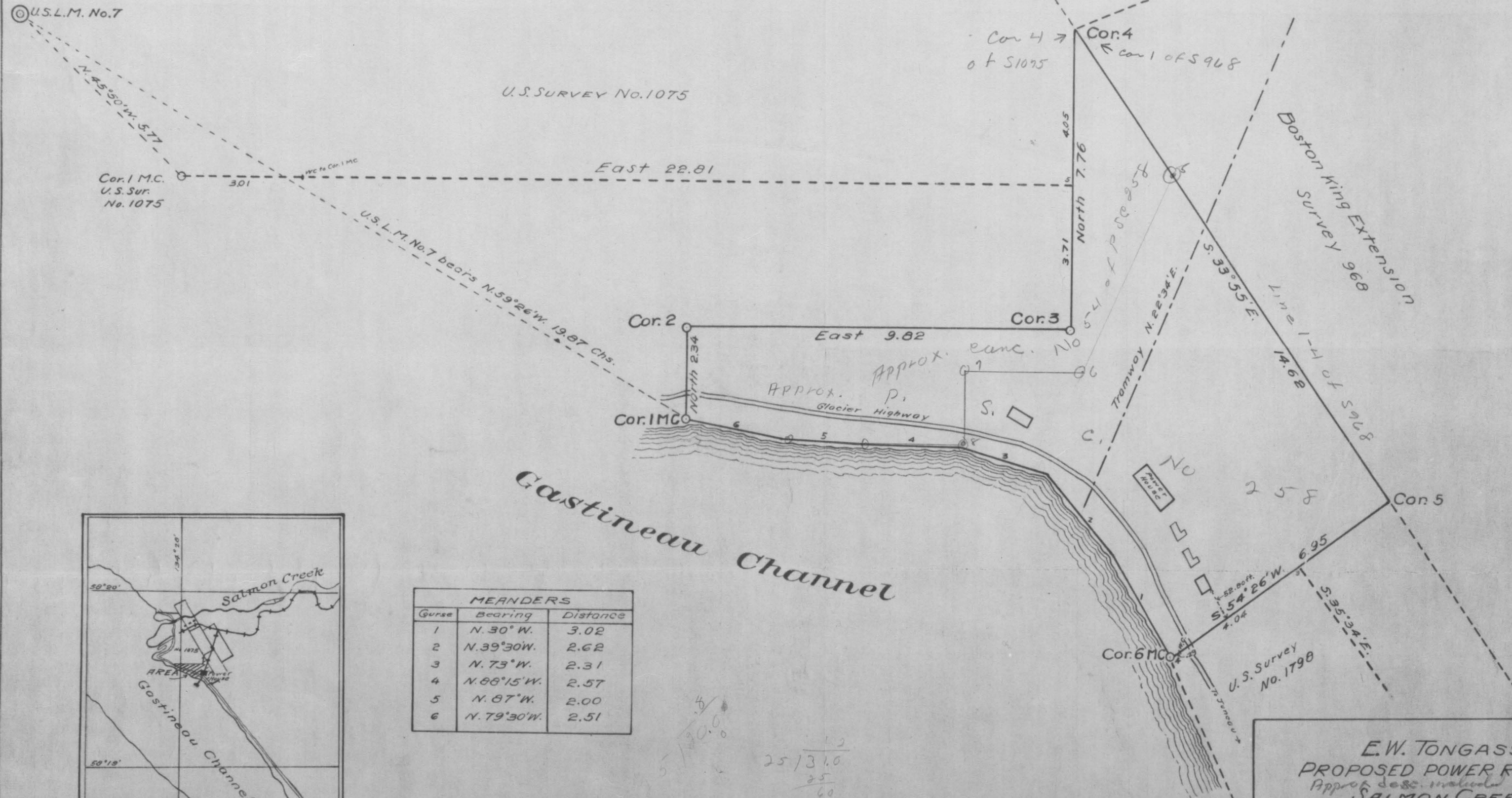

| MEANDERS | | |
|----------|---------------|----------|
| Course | Bearing | Distance |
| 1 | N. 30° W. | 3.02 |
| 2 | N. 39° 30' W. | 2.62 |
| 3 | N. 73° W. | 2.31 |
| 4 | N. 68° 15' W. | 2.57 |
| 5 | N. 67° W. | 2.00 |
| 6 | N. 79° 30' W. | 2.51 |

Handwritten calculations:

$$\begin{array}{r} 2.5 \\ \times 1.8 \\ \hline 4.5 \\ \times 2.2 \\ \hline 5.5 \\ \hline 10.0 \end{array}$$

$$\begin{array}{r} 25 \\ \times 18.3 \\ \hline 195 \\ \times 70 \\ \hline 1765 \\ \hline 4500 \end{array}$$

$$\begin{array}{r} 25 \\ \times 131.0 \\ \hline 755 \\ \times 60 \\ \hline 15180 \end{array}$$

E.W. TONGASS
PROPOSED POWER RESERVE
 Approx. desc. made in 1928
SALMON CREEK
 Survey by Harold E. Smith
 Forest Ranger Oct. 26, 1927
AREA: 9.55 Acres
 Scale: 1 in. = 2 1/2 chs. Var. 31° 30' E.